

MOTOEYE

头盔智能HUD

快速指南

本手册适用于以下产品型号
M6/M6-SE
E6/E6-SE

西安维度视界科技有限公司
www.vidoar.com

外观说明

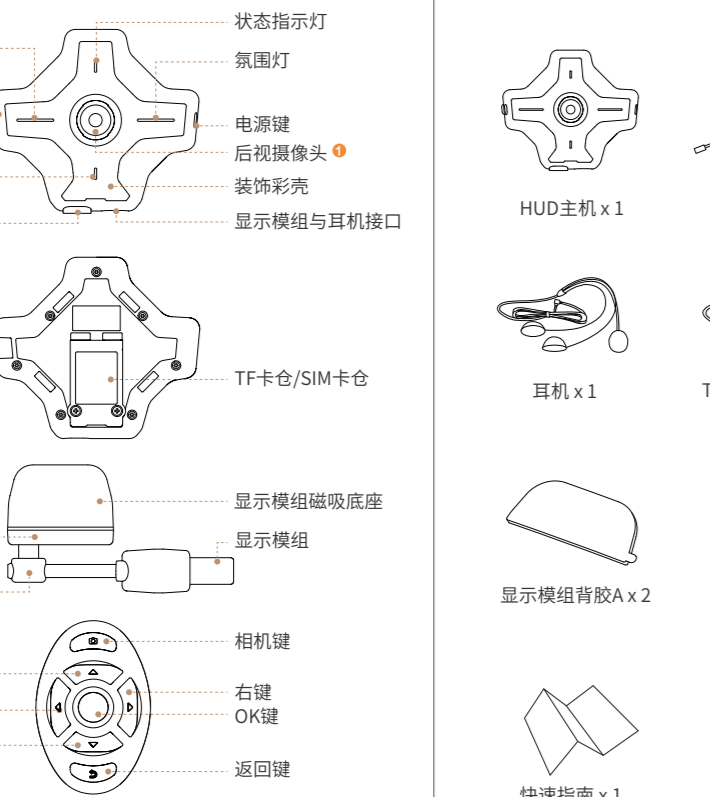

1 M6与E6，此处为后视摄像头；M6-SE与E6-SE，此处为RGB尾灯。

包装清单

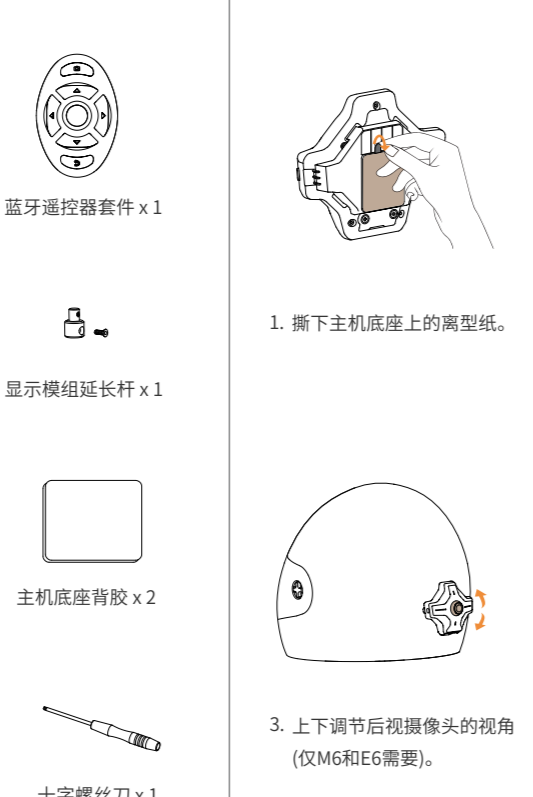

安装HUD主机

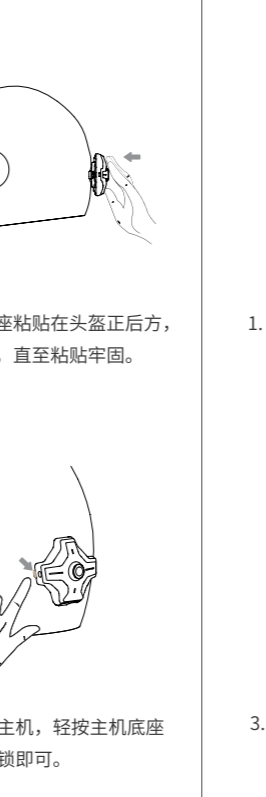

安装HUD显示模组

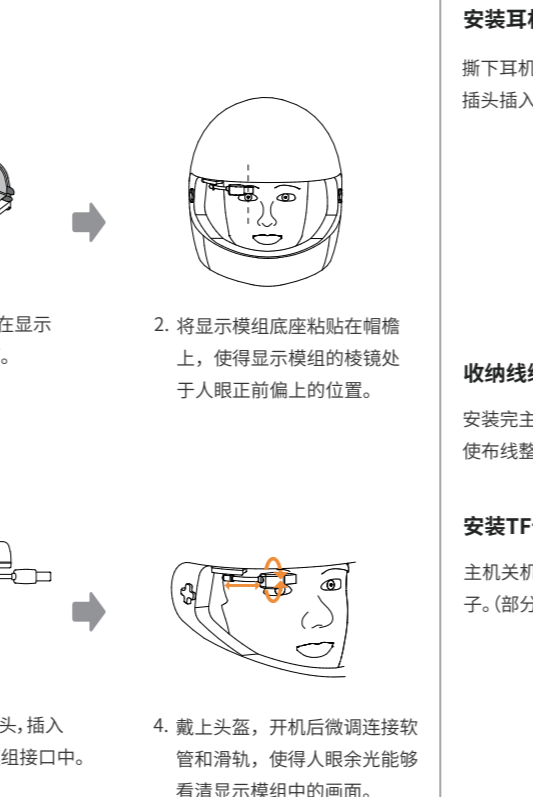

安装耳机及TF卡

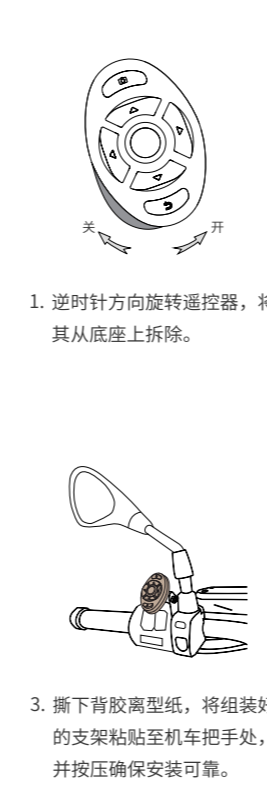
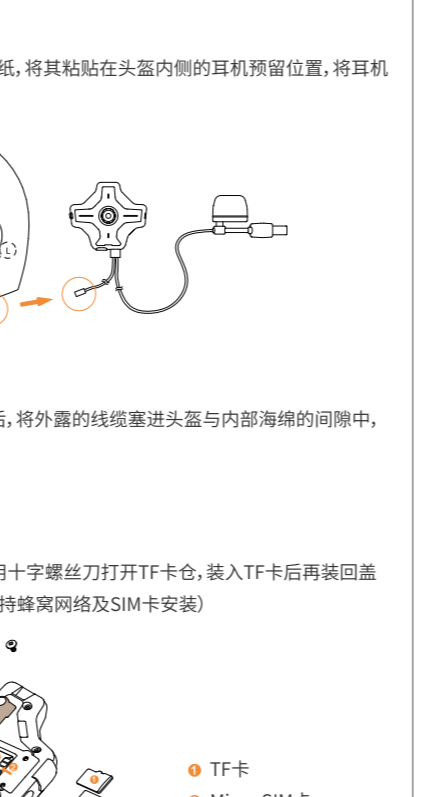

安装蓝牙遥控器



功能定义

按键

按键	短按	长按 (2s)
电源键	亮屏/灭屏	开机/关机
上键、下键	向上/向下移动	增大/减小音量
左键、右键	向左/向右移动	--
确认键	确认当前项	打开语音助手
返回键	返回到上一级	返回到主页面
相机键	打开流媒体后视镜	对讲PTT

指示灯

指示灯	亮	灭
状态指示灯-绿灯	系统开机	系统关机
状态指示灯-蓝灯	摄像头工作	摄像头关闭
充电指示灯	正在充电	充满电

1 2 3 此功能仅限具有后视摄像头的型号。

开始使用

开机/关机：
长按电源键2秒开机/关机；
HUD主机开机后，短按电源键，待机/唤醒HUD显示屏。

注意：
使用前，请先将显示模组插头连接到HUD主机上，再开机；
如发生异常，长按电源键10秒可对HUD主机进行强制重启。

充电：
请使用5V充电器对HUD主机充电；
充电时：红色充电指示灯长亮；
电量充满时：充电指示灯熄灭；
HUD主机一次充电时间约2.5小时。

音量调节：
长按上键，调大音量；
长按下键，调小音量。

手机APP下载

第一次使用时，需在手机上下载MOTOEYE APP并对HUD连接一次，HUD将自动完成语言、时区、时间等设置。
关注MOTOEYE微信公众号，获取更多教程。

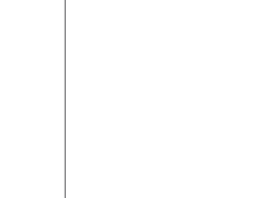

MOTOEYE微信公众号

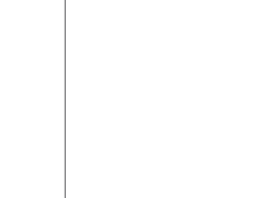

MOTOEYE手机客户端

蓝牙连接

MOTOEYE手机APP连接：

- HUD开机；
- 手机上下载MOTOEYE APP，注册MOTOEYE账号并登陆；
- 在APP主页面点击“主机”按钮，打开“设备连接”页面；
- 搜索HUD主机，并点击名称进行连接，HUD蓝牙名称为“设备型号”-“SN号”，如M6-47C132C2；
- 连接成功后，“主机”页面会显示HUD主机的设备信息。



蓝牙音频连接：

- 安卓手机：安卓手机客户端可以同时建立HUD与手机的蓝牙数据连接与音频连接（部分机型需在系统设置中手动连接蓝牙音频）；
- 苹果手机：iOS客户端仅能建立HUD与手机的蓝牙数据连接，音频连接需要到系统设置-蓝牙连接中手动连接。

互联网连接

方法一：WiFi连接

- 手机APP与HUD主机建立蓝牙连接后，点击“WiFi”按钮；
- 点击“搜索WiFi”后，选择要连接的WiFi，并输入WiFi密码进行连接。

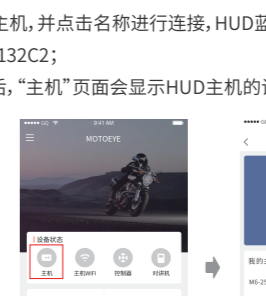

方法二：通过蓝牙共享手机网络：

- 通过蓝牙共享手机网络之前，需先在手机上做如下设置：
iPhone手机：打开“个人热点”开关；
安卓手机：打开“蓝牙共享网络”开关；
- 在HUD主机的设置菜单，进入“蓝牙共享网络”页面，点击“连接”；
- 如果打开“蓝牙共享网络”页面中的“自动连接”开关，则当HUD与手机蓝牙连接后，蓝牙网络会自动连接。

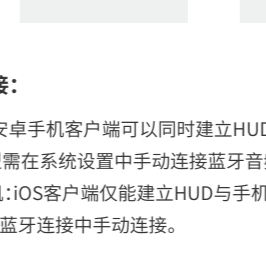

蓝牙遥控器使用

产品出厂时，HUD主机与遥控器已配对完成，HUD开机后，按下遥控器任意键等待几秒，遥控器即可与主机恢复连接。HUD关机后，遥控器会自动进入低功耗休眠模式。
按下遥控器按键，遥控器上的绿灯亮，表示电量正常。
按下遥控器按键，遥控器上的红灯亮，表示电量低，应尽快更换电池。

如果需要重新配对蓝牙遥控器，可按照下面方法进行操作：

- 同时按住遥控器的相机键与返回键3秒以上，激活遥控器配对广播，此时遥控器上的红灯与蓝灯交替闪烁；
- 手机与HUD主机建立蓝牙连接后，点击APP主页或“设备连接”页面的控制器按钮；
- 点击“搜索蓝牙控制器”；
- 选择要连接的蓝牙遥控器进行连接。



MOTOEYE

Helmet Smart HUD

Quick Guide

This manual is applicable to the following models

M6/M6-SE
E6/E6-SE

Xi'an Vidoar Technologies Co., Ltd.
www.vidoar.com

Appearance Description

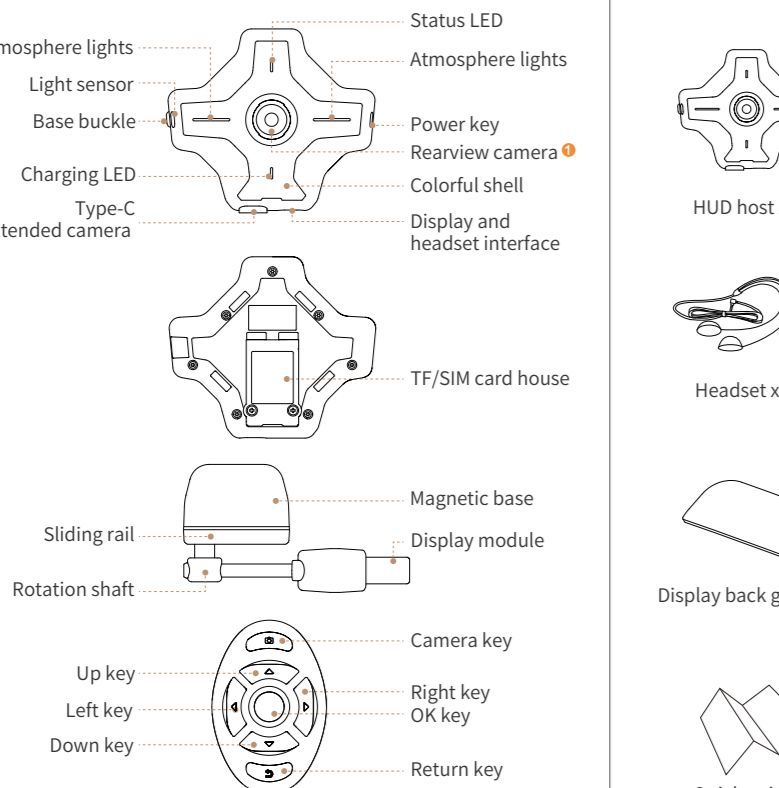

1 For the M6 and E6, this is the rearview camera location, for the M6-SE and E6-SE, this is the RGB tail light location.

Packing List

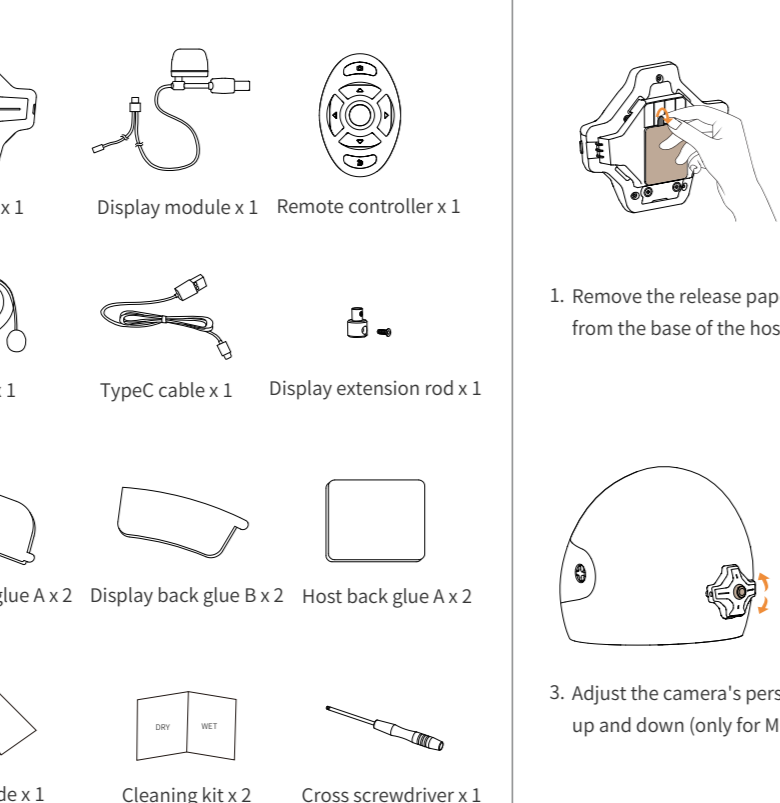

Install HUD Host

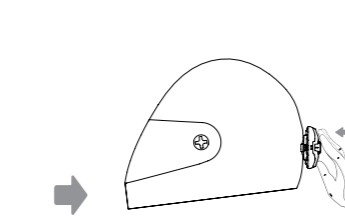

1. Remove the release paper from the base of the host.

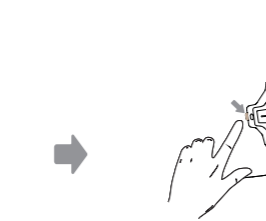

2. Stick the base of the host behind the helmet and press it down until it is firmly attached.

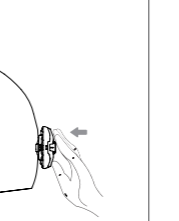

3. Adjust the camera's perspective up and down (only for M6 and E6).

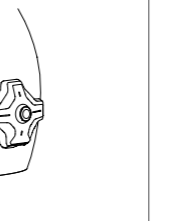

4. To remove the host, gently press the latch on the base of the host, and then remove the host.

Install Display Module

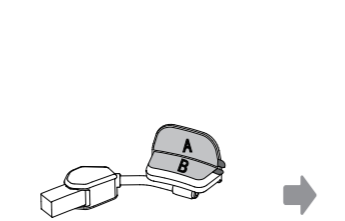

1. Paste the back glue on side A or side B of the display module base.

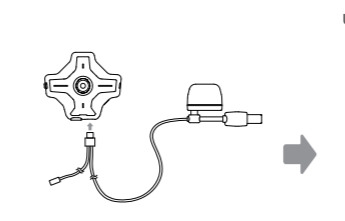

2. Paste the base of the display module onto the brim of the helmet, so that the prism of the display module is in a position that is directly forward and upward of the human eye.

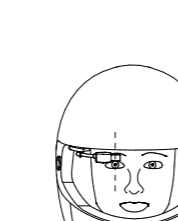

3. Insert the plug of the display module cable into the display jack of the HUD host.

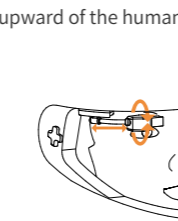

4. Putting on the helmet and power on the HUD, fine tune the rotation shaft and sliding rail, so that you can see the image in the display module clearly.

Install Headset And TF Card

Install headset

Remove the release paper on the back of the headphones and microphone, stick it to the reserved position on the inside of the helmet, and insert the earphone plug into the earphone jack.



Storage cable

After installation, insert the exposed cables into the gap between the helmet and the internal sponge.

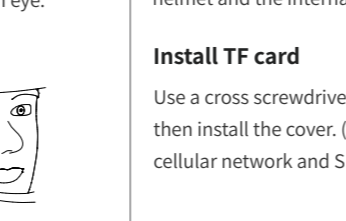

Install TF card

Use a cross screwdriver to open the TF card house, install the TF card, and then install the cover. (Some models in some countries do not support cellular network and SIM card installation)

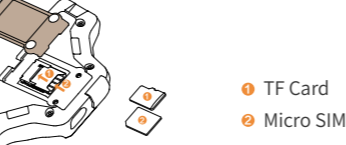

1 TF Card
2 Micro SIM Card

Install Remote Controller

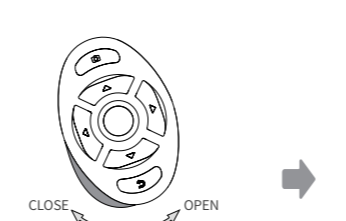

1. Rotate the controller counterclockwise to remove it from the base.

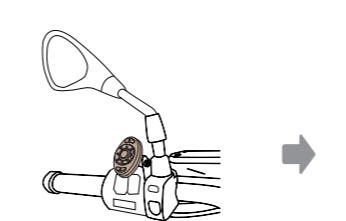

2. Use a wrench to install the controller base onto the bracket and attach the back glue to the arc position of the bracket.

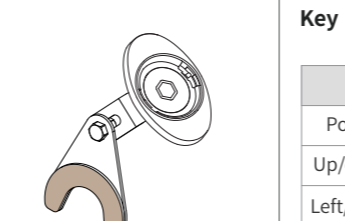

3. Remove the release paper from the bracket, paste the assembled bracket onto the handlebar, and press to ensure reliable installation.

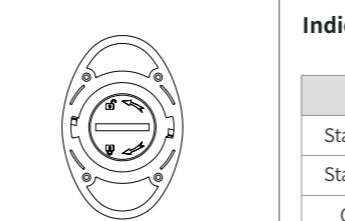

4. If need to replace the battery, you can use a coin to open the battery cover and replace the battery.

Functional Definition

Key

Key	Short press	Long press (2s)
Power key	On/off screen	Power on/off
Up/down key	Up/down move	Increase/Decrease volume
Left/Right key	Left/down move	--
OK key	Confirm	Start voice control
Return key	Return/back	Go back home
Camera key	Start rearview mirror	Intercom PTT

Indicate LED

LED	On	Off
Status LED-green	Power on	Power off
Status LED-blue	Camera is working	Camera is not working
Charging LED	Charging	Charged

1 2 3 This feature is only available for models with a rearview camera.

Start Using

Power on/off:

Press and hold the power key for 2s to power on/off. After the HUD host is power on, short press the power key to standby/wake up the Display module.

note:
Please connect the display module plug to the host before power on. If an abnormality occurs, pressing and holding the power button for 10s can forcibly restart the device.

Charging:

Please use a 5V charger. When charging: the red charging indicator light remains on. When fully charged: the charging indicator light goes off. The charging time of the HUD is about 2.5 hours at a time.

Volume control:

Long press the up key to increase the volume. Long press the down button to decrease the volume.

Download Mobile APP

When using it for the first time, you need to download the MOTOEYE app on your phone and connect to the HUD once. The HUD will Automatically complete language, time zone, time, and other settings.

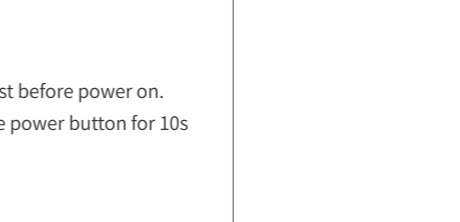

Online Manual

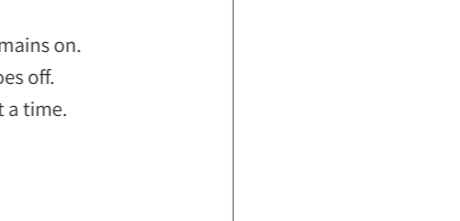

MOTOEYE APP

Product software upgrades may result in operational differences. For latest and detailed instructions of this product, please refer to the User Manual in MOTOEYE APP or scan the Online Manual QR code.

Bluetooth Connection

MOTOEYE APP connection:

- Power on the HUD.
- Download MOTOEYE mobile APP, register and log in.
- Click on the "Device" on the APP homepage.
- Search for the HUD host and click on the name to connect, the name of HUD Bluetooth is : "device model" - "SN number", such as M6-47C132C2.
- After connected, the "Device" page will display the device information.



Bluetooth audio connection:

Android phone: Android mobile APP can establish bluetooth data and audio connection between HUD and phone simultaneously. (Some models need to manually connect bluetooth audio in the system settings).
iPhone: The iOS APP can only establish a bluetooth data connection between HUD and the phone, and the audio connection needs to be manually connected in System Settings - Bluetooth Connection.

Networks Connection

WiFi connection:

- After establishing the bluetooth connection, click the "WiFi" button.
- Select the WiFi you wanted and enter the password to connect.

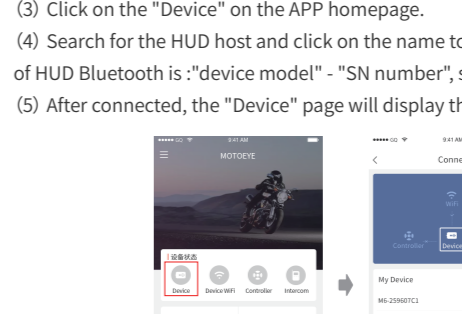

Share mobile network through bluetooth:

- Before sharing the mobile network through bluetooth, the following settings need to be made on the phone:
iPhone: Turn on the "Personal Hotspot" switch.
Android phone: Turn on the "Bluetooth shared network" switch.
- In the settings menu of the HUD host, enter the "Bluetooth network" page and click "Connect".
- If turn on the "Auto Connect" switch on the "Bluetooth network" page, the HUD will automatically connect to the network after connected to the phone's bluetooth audio.

Using The Remote Controller

After the HUD is turned on, press any key on the remote controller and wait for a few seconds. The controller can resume connection to the HUD. After the HUD shuts down, the remote controller will automatically enter low-power sleep mode.

If you need to pair the Bluetooth remote controller again, you can proceed as follows:

- Press and hold the camera button and return button of the controller simultaneously for more than 3 seconds. At this time, the red and blue lights on the remote control flash alternately.
- After establishing a Bluetooth connection between the phone and the HUD host, click the controller button on the APP homepage or "Device Connection" page.
- Click on "Search bluetooth Controller".
- Select the bluetooth controller to connect to.

